

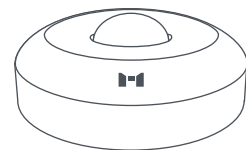

MTronic Motion And Light Sensor



QUICK START GUIDE

EN

Product Overview 2

MTronic Motion and Light Sensor is a ceiling-mounted sensor. It is capable of detecting motion and light intensity in the vicinity of its installation. The sensor triggers devices configured for it upon motion and light detection.

Motion and Light Sensor's Status LED

Status LED	Description
Blinks blue twice and blinks red once	Sensor is unprovisioning
Blinks green for 60 seconds	Sensor is provisioning
Blinks blue once	Sensor has detected motion
Blinks red once	Sensor has not detected motion for the specified time

Package Contents/Tools Required 3

The package consists of the following items:

1. MTronic Motion and Light Sensor x1
2. Screws x 2
3. Mounting Bracket x1
4. Quick Start Guide x1
5. Warranty Card x1

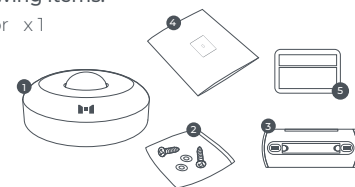

You will require the following supplies to setup MTronic Motion and Light Sensor:

- A cross slot screwdriver
- 2 x AA batteries

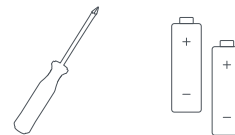

Safety Instructions 4

⚠ Danger! Note about hazard	⚠ Warning! Note about potential hazard
---------------------------------------	--

DOs

- Make sure to add the batteries to the device as per correct terminal markings.
- Make sure to mount the device on the ceiling.
- Make sure there is no hinderance in front of the device for it to function properly.
- Operate the device only within indoor environments to keep it sheltered from all weather conditions.
- Ensure the batteries in the motion sensor are properly inserted.

Safety Instructions 5

DON'Ts

- The device must not be used in an explosive atmosphere.
- Do not open or try to repair the device by yourself nor use it if any of its parts is broken.
- Do not allow children to play with the device or it's packaging as its plastic film and small components may pose a choking hazard to them.
- Do not dispose-off the device and batteries with other household garbage. It should be recycled according to the National regulations.
- Do not mount the device in front of AC or heater to prevent it from false triggers.
- Do not mount the device in damp rooms or wet areas.

Installation 6

1. Open the sensor by loosening three screws at its back using a cross slot screwdriver.
2. Add the 2 x AA batteries into it as per the terminal marking.

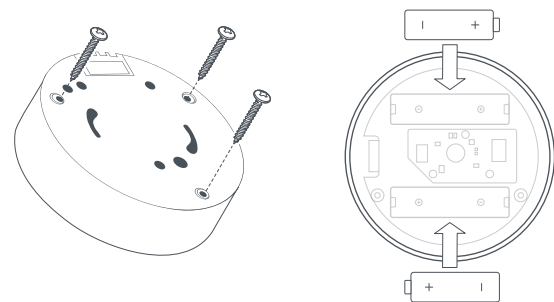

Installation 7

3. Attach the mounting bracket to the ceiling using the provided screws.

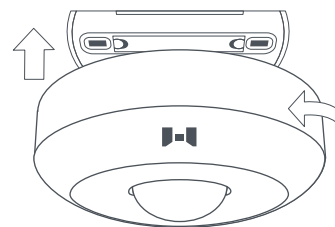

Installation 8

4. Press the button at the sensor's back to make it available for pairing with the MTronic MHub.
5. Mount the sensor on the ceiling by attaching it to the mounting bracket.
6. Navigate to MTronic Help Center (support.mtronic.pk) and follow the steps in the Motion Sensor product category to provision Motion Sensor with the application.

Note: To reset Motion Sensor, press the power button at its bottom for 10 seconds until the light starts blinking.

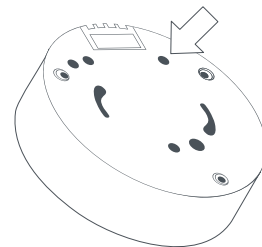

Technical Specifications 9

Specification	Details
Item Type	Motion and Light Sensor
Available Color	White
Material	ABS Plastic
Control Method	Wireless
Dimensions	96 x 50 mm
Weight	95.5 grams
Input Power	2 x AA Batteries
Mounting Type	Indoor Ceiling
Interface	Short-Range Mesh Technology 5.0, IEEE 802.15.1
Dependency	MTronic MHub
Compatibility	Google Home, Amazon Alexa
Working Temperature	-25°C ~ +50°C
Humidity	85%

Technical Specifications 10

Radio Specifications

Wireless Communication	Short-Range Mesh Technology
Short-Range Technology Module	2.360-2.500 GHz
Frequency	

Antenna Properties/ Antenna Gains

Transmitter Power	+4dBm
Antenna Gain	-0.1dBi

Disclaimers

- MTronic disclaims the responsibility for any property or material damage and personal injuries caused by the incorrect installation, handling, or usage of the MTronic Motion and Light Sensor.
- MTronic disclaims responsibility for the consequential damage caused by the opening of MTronic Motion and Light Sensor by yourself.

