

MTronic Smart Dimmer

POWER SPECIFICATIONS

Input Voltage	230 VAC , 50/60 Hz
Standby Power	< 1 Watt
Max Load	Incandescent Bulbs: 0.65A @230 VAC (150W) Leading-Edge Dimmable LEDs: 0.65A @230 VAC (150W) Fan: 0.8A @ 230 VAC (150W)

CONNECTIVITY SPECIFICATIONS

Interface	Short-Range Mesh Technology 5.0 , IEEE 802.15.1
Control Levels	6
Device Modes	Fan Dimmer, Light Dimmer
Dependency	MTronic MHub
Compatibility	Google Home, Amazon Alexa Assistant

TEMPERATURE AND HUMIDITY SPECIFICATIONS

Working Temperature	-25°C ~ +50°C
Humidity	85%

PHYSICAL SPECIFICATIONS

Item Type	Dimmer
Available Color(s)	White, Black, Gold, and Grey
Material	ABS Plastic and Tempered Glass
Control Method	Touch and Wireless
Dimensions	86 x 86 x 36 mm

RADIO SPECIFICATIONS

Wireless Communication	Short-Range Mesh Technology
Short-Range Mesh Technology Frequency	2.402-2.480 GHz

DESCRIPTION

MTronic Smart Dimmer is a smart gang switch that allows you to control the light intensity and fan speed levels. It can operate in two modes, such as Fan Dimmer and Light Dimmer and is capable of handling up to six levels.

WORKS WITH

- MTronic Web Portal
- MTronic Android Application
- MTronic iOS Application

TECHNICAL DRAWING IN MM

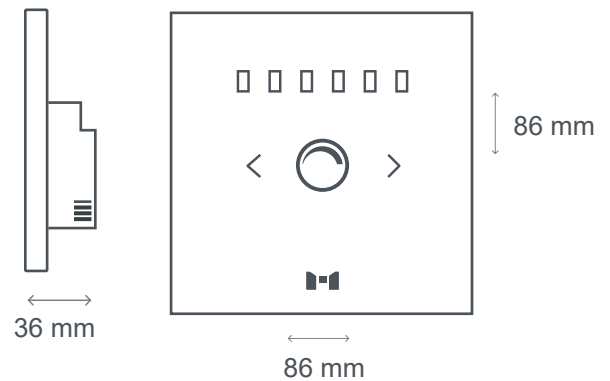

WIRING DIAGRAM

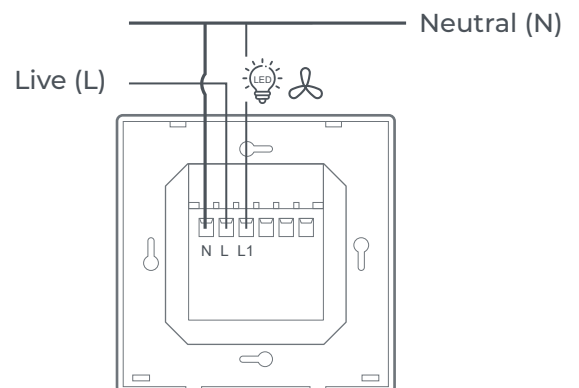

ANTENNA PROPERTIES/ ANTENNA GAINS

Transmitter Power	+9dBm
Antenna Gain	3.96 dBi



IN THE BOX

1. MTronic Smart Dimmer x1
2. Screws x 2
3. Quick Start Guide x1
4. Warranty Card x1

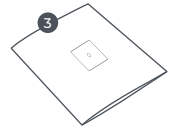
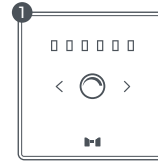

SAFETY INSTRUCTIONS

▲ Danger!
Note about hazard

⚠ Warning!
Note about potential hazard

Dos

- ▲ 1. Tighten or loosen the screws when no Live wire is connected.
- ▲ 2. Since the installation requires working with high voltages, it MUST be installed and uninstalled by an expert electrician
- ⚠ 3. Use the device only under 2000m altitudes.
- ⚠ 4. Ensure there are appropriate fuse/circuit breakers installed for the space and turn them off before installation. Turn them on only after the installation is done.
5. Operate the device only within indoor environments to keep it sheltered from all weather conditions.
6. Wear insulation gloves, use wire nuts/electrical insulation tape to insulate the wire joints or stripped parts of the wire, and trim the extra wire to avoid electrocution and short-circuiting.
7. Use a wire gauge to select the wire size as required. Use 26~14 AWG solid or stranded wire preferably.
8. Make sure the panel has no gap with the wall that allows its removal with bare hands. Also ensure that the screw terminals and wires in it are correctly seated.
9. Use a slotted screwdriver that fits well in the casing lock, or it will damage the lock.
10. After installation, clean the glass top of the device well such that it has no grease, moisture, or covering on it.

Don'ts

- ▲ 1. The device must not be used in an explosive atmosphere.
- ⚠ 2. Do not open the device by yourself nor use it if any of its parts is broken.
- ⚠ 3. Do not interchangeably use the Neutral and Live wires.
- ⚠ 4. Do not try to repair the device by yourself.
- ⚠ 5. Do not allow children to play with the device or its packaging as its plastic film and small components may pose a choking hazard to them.
6. Do not place the device in an exposed setting after connecting the load.
7. Do not dispose-off the device with other household garbage. It should be recycled according to the National regulations.
8. To avoid short-circuiting, do not peel off the plastic from the wire more than required.
9. Do not use a dripping wet cloth to clean the device.
10. Do not install the device in damp rooms or wet areas.
11. Do not leave the space between panel and wall as the water may seep into the panel only from the wall.

FAULT CORRECTION AND MAINTENANCE

Warning

Opening the device by yourself nullifies the warranty. Generally, the device is maintenance-free and would not require to be opened.